

f. When using the monitoring belt, please make sure that no vibration source is close to ensure that the monitoring belt can accurately detect the user's sleep. Such as washing machines, loud music and other vibration source may cause misjudgment of this product.

g. In order for APP to provide you with accurate sleep monitoring reports and suitable sleep aid programs, please do not turn over, get up, or get out of bed deliberately.

5.Troubleshooting

Troubleshooting

Fault phenomenon	Check items	Solutions
Unable to turn on	Whether the host battery is low	Please charge if the battery is low
	Whether the charging is normal	After the correct connection, the charging indicator light is always on
Unable to charging	Whether the charging connection is correct	After the correct connection, the charging indicator light is always on
Shows normal, no response or no feeling	Whether the wire is connected correctly	Check the wire connection
	Whether the electrode is properly touching the skin	Check whether there is a partition between the electrode and the skin
	Whether the intensity is adjusted normally	Check whether it has been adjusted to the proper intensity
	Whether to turn on the output	Check whether the output has been turned on

Precautions

We suggested do not use this product in the following situations for the safety of the patient:

This product is forbidden to be used with the following medical electronic devices:

- a.Implantable medical electronic devices such as cardiac pacemakers;
- b.Medical electronic devices such as artificial heart and lungs;
- c.Electronic device such as electrocardiograph;

In the following cases, you must consult a doctor before use.

Otherwise, it may occur accidents or physical discomfort:

- a. Patients who are being treated by a doctor and feel abnormalities;
- b. Patients with abnormal heart and brain nerves;
- c. Patients with impaired skin perception or skin abnormalities;
- d.Pregnant women and parturients;
- e. Patients with sensory disturbances due to diabetes and other high-level peripheral circulatory disturbances;

f. Patients with infectious diseases;

g. Patients with malignant tumors;

h.People with sensitive skin;

i.Patients who cannot express their wishes freely.

It is forbidden to use the device and monitor while charging.

It is forbidden in gas stations, high dust workshops, gas stations and other flammable and explosive places.

Do not use it for children or people who are not capable of expressing consciousness.

Do not drive or operate potentially dangerous machines during the sleep aid process and within 2 hours after use.

Place the device away from electromagnetic interference, and do not answer the phone when using the device.

If there is a slight tingling sensation, just reduce the intensity of the micro-current output to relieve it.

If you find that the ear clip is in contact with human skin and feel uncomfortable, you should stop using it in time

If the device is damaged, please stop using it and ask a professional to repair it.

It is forbidden to disassemble, repair and modify this product

without authorization.

Avoid collision and water ingress with this product to avoid malfunction.

It is forbidden to wash this product with water.

The accessory wires and ear clips of this product can only be used with the host, do not interconnect with other devices.

If you feel any discomfort during use, please stop using it immediately.

It is recommended for people who are 14 years old and above.

When disposing of this product, please dispose of it in accordance with the city's relevant environmental protection regulations, otherwise it may cause environmental pollution.

Cleaning and Storage

When cleaning the device and monitor, please turn off the host, use a soft cloth or towel dampened with some water to wipe, and do not soak or rinse in water.

During the cleaning process, prevent water or other liquids from entering the body to avoid short circuit and electric shock hazards during use.

Please do not place monitoring belt in water for washing. If you need to clean, please wipe the surface with a soft cloth dampened with a little water, and ventilate it to dry in time.

When cleaning the ear clips, use medical alcohol to wipe and disinfect.

When storing the product for a long time, please fully charge the battery of the device in advance.

If you do not use this product for a long time, please store the device, monitor and monitoring belt (lightly rolled up) in a dry and ventilated place. Never fold or compress the monitoring belt, otherwise it will cause damage to the monitoring belt.

Do not store it in a place exposed to direct sunlight, high temperature, or humidity.

Technical parameters and specifications

Product name: Mini3 Pro CES Insomnia Relief device

Model No.:Mini3 Pro Pulse width:200-1100ms

Power supply:5V DC 1A Pulse shape: square wave

Input power:3W Storage temperature: -10°C~55°C

Charging time:1-2 hours Relative humidity: 10%~85%RH

Pulse frequency:0.8-1.2Hz Lithium battery :3.7V DC 1000mAH

Error range: ±5%

After-sales and maintenance

This certificate is used after purchasing the device, when after-sales maintenance service is required , please keep it properly.

After-sales maintenance service rules as below:

1.Please read the product manual carefully before use and fill in the warranty card.

Under normal conditions, you can enjoy a free warranty within one year with the host,3 months with the accessories(no for gift).

2.Repairs and man-made damages to products beyond the warranty period will be charged for material costs and freight.

3.In one of the following situations, the company does not provide free warranty, but can provide full charge for repairs according to the consumers requirement.

The product is out of warranty.

Consumers damage the product because of improper use and maintenance.

Without warranty card certificate and valid invoice.

The warranty card model No. does not match the repaired product model or altered.

Damaged due to force majeure.

After-sales service hotline: 400-875-9808.

Warranty Card (Saved by the customer)

Dear customers:

Thank you for using our products, and in order to provide a better service to you, please fill in the following carefully:

Product name: CES Insomnia Relief Device

Model No.: Mini3 Pro

Warranty period: From the date of purchase, the host has a free warranty for one year, and the warranty period for wires and other accessories is three months. (Except gifts).

Factory code: _____

Customer name: _____

Contact address: _____

Tel: _____

Purchasing address: _____

Purchasing date: _____

After-sales and warranty service company: Shenzhen Sorosis Intelligent Technology Co., Ltd

After-sales and maintenance address: Building B, Junsd Science and Technology Park, Watch Base, Matian Street, Guangming District, Shenzhen City, China

Tell:86-755-83789006

Hot line:400-875-9808

Post code:518106

Warranty Card (Ship with product)

Dear customers:

Thank you for using our products, and in order to provide a better service to you, please fill in the following carefully:

Product name: CES Insomnia Relief Device

Model No.: Mini3 Pro

Warranty period: From the date of purchase, the host has a free warranty for one year, and the warranty period for wires and other accessories is three months. (Except gifts).

Factory code: _____

Customer name: _____

Contact address: _____

Tel: _____

Purchasing address: _____

Purchasing date: _____

After-sales and warranty service company: Shenzhen Sorosis Intelligent Technology Co., Ltd

After-sales and maintenance address: Building B, Junsd Science and Technology Park, Watch Base, Matian Street, Guangming District, Shenzhen City, China

Tell:86-755-83789006

Hot line:400-875-9808

Post code:518106

Tips : Please scan this page and mail it with the product

INSTRUCTION MANUAL

Mini3 Pro

CES Insomnia Relief device Instruction Manual

Product Description

Mini3 Pro is a high-tech intelligent sleep solution product that integrates insomnia relief, sleep monitoring and sleep report visualization on the APP. It monitors the user's heart rate, respiration rate, snoring and other vital signs data through high-sensitivity non-contact sensors, counts the user's body movement changes during sleep, generates statistical reports of deep sleep and light sleep, and provides monthly, Weekly, daily and every nap of sleep quality report and sleep improvement suggestions. Users can use the device to help sleep in a targeted manner according to the improvement suggestions by the APP, so as to achieve the purpose of effectively improving sleep.

Mini3 Pro insomnia relief device principle: applying Cranial Electrotherapy Stimulation (CES), a pair of electrodes clamped on the earlobe transmits a special waveform of microcurrent to the central nervous system of the brain, prompting the brain to secrete a series of nerves related to emotions and sleep,improving abnormal brain waves to sleep better and easier.

Product Configuration

Insomnia relief device	Ear clip
Monitor (as charging base)	Ear clip Cable
Sleep monitoring belt	Type-C charging cable
Instruction Manual	Quick start guide
Warranty card	Certificate of Qualification
Portable storage bag	

Product structure

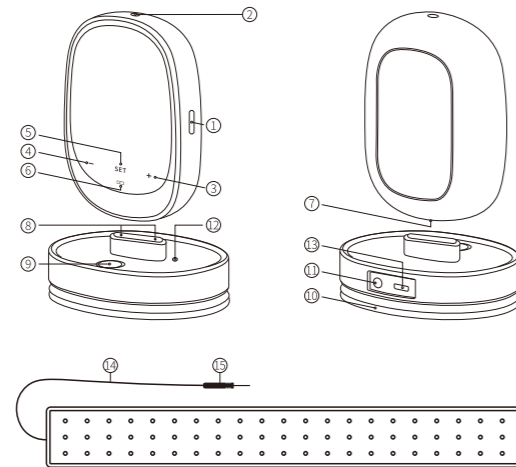

Insomnia relief device:

- ①Power button/Output switch button
- ②Pulse output interface
- ③Turn up the intensity/Parameter selection button
- ④Turn down the intensity/Parameter selection button
- ⑤Setting switch button
- ⑥ charging indicator
- ⑦Magnetic charging interface

Monitor:

- ⑧Magnetic charging connector
- ⑨Power button
- ⑩Monitor magnetic cover
- ⑪Connection interface
- ⑫Charging indicator
- ⑬Type-C charging cable

Monitoring belt:

- ⑭Connection cable
- ⑮Connector

Operating Manual

1. Use of accessories

The earclip cable is used to connect the ear clip and the pulse output interface of the host.

Ear clips are used to deliver special waveform micro-currents to the central nervous system of the brain.

The monitoring belt is used to collect a series of sleep-related datas such as the user's heart rate, respiration rate, body movement changes, deep sleep duration and light sleep duration during sleep.

Note: Before using

Please check whether the ear clip wire, ear clip and host are properly connected.

Please wipe and moisten the electrode surface of the ear clip with alcohol or water.

The ear clips should clamp both earlobes of the user at the same time so that the electrodes fit the skin.

Please check whether the monitor is properly connected to the sleep monitor.

Please spread the monitoring belt horizontally on the bed (the position corresponding to the chest cavity in the supine sleeping position) and connect it to the monitor host.

Please make sure turn on the monitor and connected with the SoroSis Intelligent + APP successfully, and the monitoring function can be turned on on the APP.

2. Charging

Insert the magnetic charging port of the monitor into the magnetic charging head of the sleep monitor, plug the Type-C cable connector into the 5V DC power supply, and plug the other end into the power interface of the monitor. After the charging power supply is properly connected, charging will start and the monitoring charging indicator of the device is always on, and the charging indicator of the insomnia relief device is green.

The insomnia relief device must be charged with the magnetic charging port inserted into the magnetic charging head of the machine. The monitoring can be charged separately. Please charge the battery fully for the first time.

During charging, the insomnia relief device charging indicator will be green, and when the battery is full, the charging indicator will be blue.

When charging, do not use the insomnia relief device and monitor.

3.Operation instructions

Power on:Press the power button for 5 seconds to turn on, and the screen will light up. The default time displayed at this time is 20 minutes, and the current intensity is 0.

Set up timer:Tap the SET button on the screen to select time. There are three levels of time can be chosen: 20 minutes, 40 minutes, and 60 minutes.

Turn on:After selecting the duration, tap the switch on the right side of the host once to start, and the screen will display a countdown at this time.

Set up intensity:Tap the "+" and "-" buttons on the screen to adjust the intensity.

Auto power saving mode:After the therapy is completed, the device will automatically enter the sleep state if 5 minutes no operation, 10minutes no operation automatically shut down.

Low battery display:In a low battery state, the charging indicator turns red, please charge the device in time according to the above 2 charging operations.

Turn off:Press and hold the power button for 5 seconds to power off.

4.Operational recommendations:

a. Please clean your earlobes before using, and remove ear studs, earrings and other ear decorations.

b. It is recommended to increase the intensity gradually from low to high, and the intensity can be adjusted according to personal

adaptation when first time using. During use, the earlobe will have a slight tingling sensation or head dizziness, which is a normal phenomenon. It also shows that the CES micro-current stimulation is working, and it can be relieved by lowering the intensity.

c.Do not exceed 1 hour for everytime use, and the interval between two uses must be 1 hour or more.

d.Each time you use the device, select the duration first, then tap the power button once to confirm, and then tap the "+" and "-" buttons on the screen to increase or decrease the intensity.

e. When using the device, the ear clips should clamp both earlobes of the user at the same time, so that the electrodes are attached to the skin before adjusting the intensity to a suitable position.

f. While using insomnia relief device, you can sit or lie down, and can also read, work, clean or watch TV but please try not to answer the phone at the same time. Answering the phone may cause interference to the device or even damage the device.

g.The Mini3 Pro is a CES drug-free device, and the therapy effect is a gradual process. In our experienter program, 85% of the experiencers of different ages reported that the continuous use of about 7-15 days will have a significant sleep improvement effect. Therefore, patience and perseverance are also important factors for obtaining satisfactory results.

h.Please advance two hours to use the device before go to bed for the best therapy effect.

5.Operating instructions of the monitor

Monitoring belt installation:Lay the monitoring belt horizontally on the bed (the position corresponding to the chest cavity in the supine sleeping position), and cover the sheets.

Fixed monitor:After the monitoring belt is connected to the monitor, the monitor is fixed on the bed sheet with a magnetic cover.

Power on:Press and hold the power button for 3 seconds, the indicator will flash 3 times and then turn on the device, and the

indicator will turn off after the device is turned on.

Connect with APP:Follow the instructions on the APP monitoring interface to successfully connect to the monitor and enter the monitoring interface. The indicator light remains blue at this time.

Sleep monitoring:After the monitor is connected to the APP, you can lies on the monitoring belt and clicks "Start falling asleep" on the APP sleep monitoring interface to start monitoring.

Stop the monitoring:After you get up, click "Stop Sleep" on the APP to stop monitoring.

Sleep report:You can view the sleep report when you click "Stop Sleep" on the APP.

Turn off:Press and hold the power button to the indicator light on, then release the switch, and the indicator light goes out after power off.

Operational recommendations:

a.The monitor is not charged and will not cause any harm to the user.

b.Please spread the monitoring belt flat on the mattress, and do not put the monitoring belt directly on the bed sheet to prevent the monitoring belt from moving during use and affecting the accuracy of the monitoring.

c. Do not bend the monitoring belt during use, as bending may damage the internal sensor.

d. Do not touch the product with high temperature equipment, and do not use it with heating device such as electric blankets.

e. The monitor and the monitoring belt can only monitor and collect the sleep information of one person at the same time. Please do not use it by multiple people at the same time, otherwise it will affect the accuracy of data collection.

e.The monitoring belt is suitable for a flat and stable surface. Please do not put the monitoring belt on a bed with activity function (such as a hammock). It may cause the sensor belt to fail to perform its normal function.

www.szsangguo.com

Download SoroSis Intelligent + APP

Users can download SoroSis Intelligent + APP by scanning the following two-dimensional code, or go to the official website (please click on this link: <https://www.szsangguo.com/>) of SoroSis Intelligent to download.



SoroSis Intelligent + APP video operation guide

Users can watch the video of SoroSis Intelligent + operation guide by scanning the following QR code to learn more about the operation method of SoroSis Intelligent + APP.



Shenzhen SoroSis Intelligent Technology Co., Ltd.

Address: Building B,Junsd Science and Technology Park,Watch Base,Matian Street,Guangming District,Shenzhen City,China

Postcode: 518106

General: 400-875-9808

Fax: 0755-25324292

Web: www.szsangguo.com